

THE INFORMATION CONTAINED IN THIS DRAWING IS THE SOLE PROPERTY OF
 YOLONG INDUSTRIAL CO., LTD. > ANY REPRODUCTION IN PART OR AS A WHOLE
 WITHOUT THE WRITTEN PERMISSION OF (INSERT COMPANY NAME HERE) IS PROHIBITED.

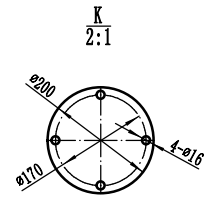

| Technical parameter | | |
|-----------------------------|--------------|-------------|
| | Inner shell | Outer shell |
| Material | 316L | SUS304 |
| Thickness | 3mm | 2mm |
| Heating area m ² | 2.6 | |
| Insulation | Mineral wool | |
| Total volume | 36BBL | |
| Working volume | 15BBL | |
| Net weight | 1700 Kg | |

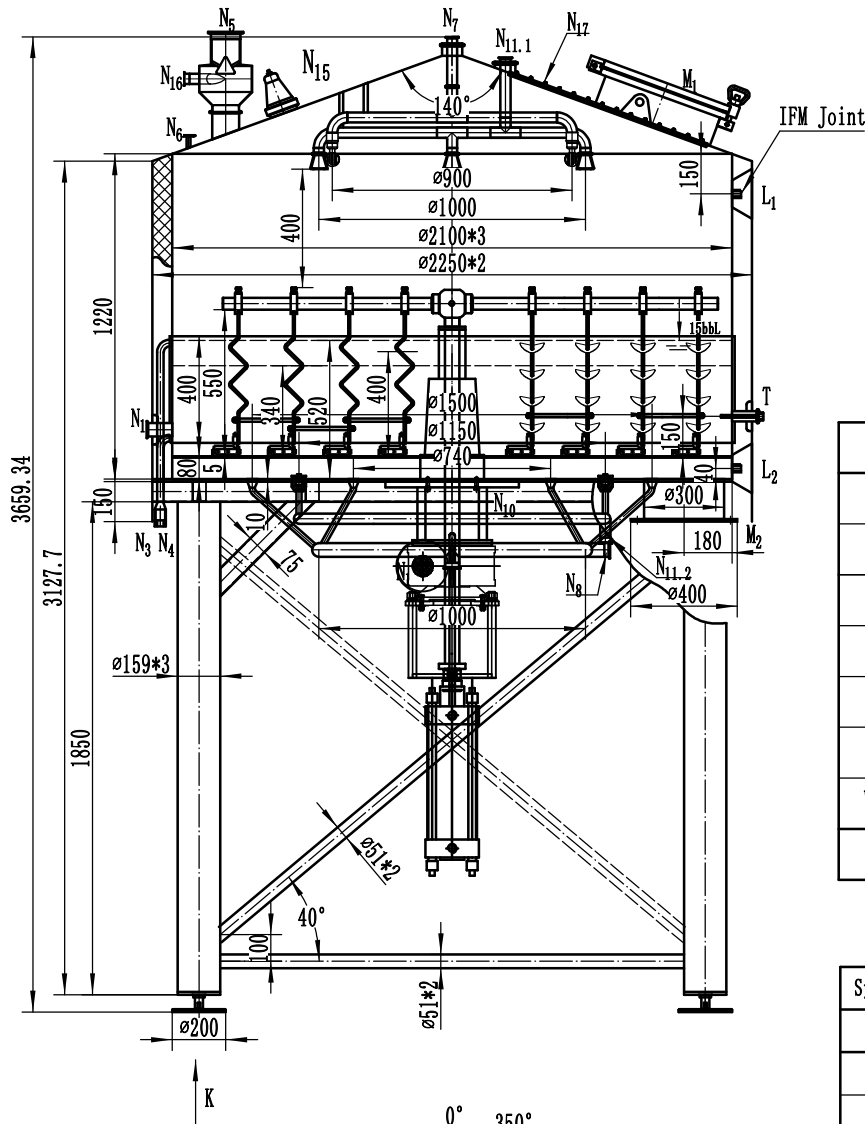
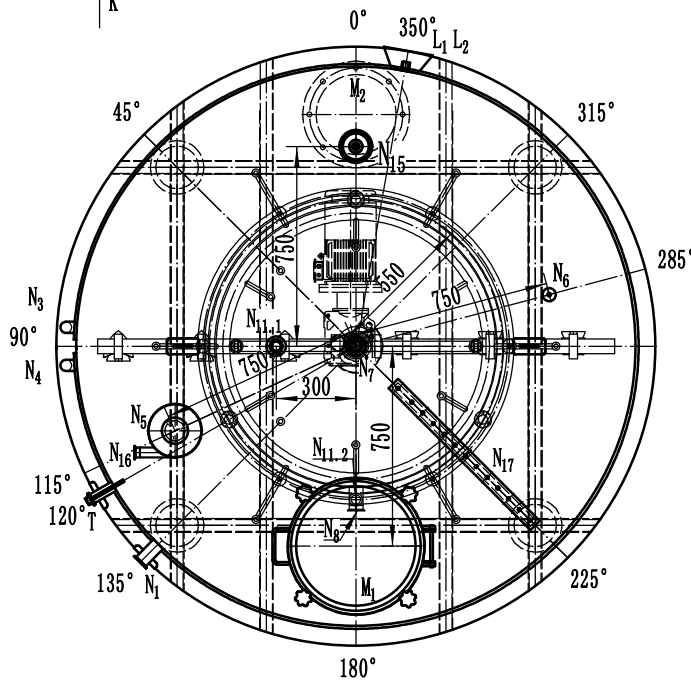

Specification

| Symbol | Spec | Connecting Style | Usage |
|-------------------|-----------|------------------|-----------------------|
| M ₁ | ø450 | Welding | Glass manway |
| M ₂ | ø300 | Flange | Grain outlet |
| N ₁ | 2" | Tri-clamp | Wort inlet |
| N ₃ | 0.75" | NPT | Condensation outlet |
| N ₄ | 1" | NPT | Steam inlet |
| N ₅ | 4" | Tri-clamp | Hydrator |
| N ₆ | 0.5" | Tri-clamp | CO ₂ inlet |
| N ₇ | 3"-1.5" | Tri-clamp | Sparge |
| N ₈ | 2" | Tri-clamp | Wort outlet |
| N ₁₀ | ø450 | Welding | Reducer (2.2KW) |
| N _{11.1} | 3"-1.5" | Tri-clamp | Spray ball |
| N _{11.2} | 1.5" | Tri-clamp | Flush nozzles |
| N ₁₅ | 4" | Bevel seat | Tank light |
| N ₁₆ | 1.5" | Tri-clamp | Water inlet |
| T | 1.5"-0.5" | Tri-clamp/NPT | Thermowell |
| L | 1" | Thread | Pressure sensor |
| N ₁₇ | 750*50 | Flange | Repair window |

| | | | |
|-----------------------|------------|------|------------|
| Project No. | | | |
| Drawing No. | | | |
| Version No. VI.2 | | | |
| Customer Confirmation | | | |
| Designer | jason wang | Date | 2018.11.22 |
| Draft man | | Date | |
| Proofreading | | Date | |
| Reviewer | | Date | |

15BBL LAUTER-D2100

SUS304

YI-04-1106A17

| Drawing Mark | Quantity | Weight | Scale |
|--------------|----------|--------|-------|
| | | | 1:20 |
| Total | Page | page | |

YOLong YOLONG INDUSTRIAL CO., LTD.